

# 3 Prebijalna igla Cutting Punch

# Pozavnasta rezilna igla Bottle-Neck Punch

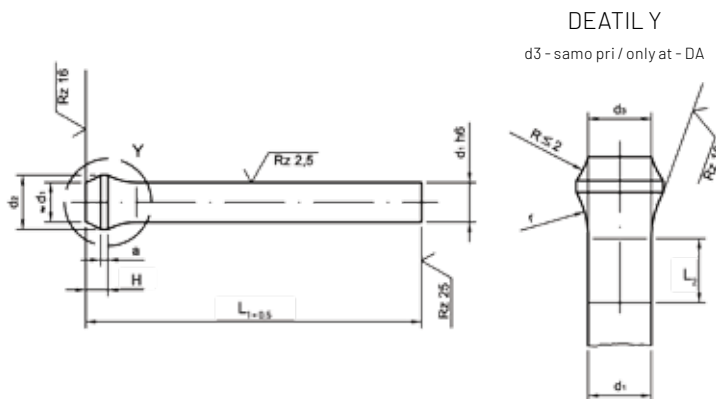

## Pozavnasta rezilna igla s cilindričnem stebлом.

Bootle-neck punch pins with  
cylindrical shank.

### Obseg uporabe:

Za stiskalna orodja z ekstremno visokimi zahtevami.  
Dimenzije so prikazane v tabeli.

### Prileganje / Toleranca:

Steblo d1

0,5-3	3-6	6-10	10-16	16-20	20-25	
h6	-0,006	-0,008	-0,009	-0,011	-0,013	-0,015

Dolžina L1+0,5

### Material:

HWS (visoko legirno jeklo za delo v hladnem - 12% krom) / HSS (hitrorezno jeklo)

### Karakteristike:

HWS: visoka trpežnost, dolga življenjska doba  
HSS: ekstremno visoka trpežnost, za materiale s katerimi se težko dela. Velika odpornost proti obrabi, visoka natezalna trdnost, visoka odpornost proti vročini.

### Trdota HRC:

Steblo: HWS 60 - 64, HSS 62 - 66  
Glava: HWS in HSS 45 - 55

### Obdelava:

Kaljeno, napuščeno, steblo precizno brušeno, pozavnasta glava vroče kovana z dovoljeno nabrekli (d3) takoj pod glavo.

### Range of application:

For pressing tools with extremely high requirements.  
The dimensions are shown in the table.

### Fit / Tolerance:

Nominal diameter stem d<sub>1</sub>

0,5-3	3-6	6-10	10-16	16-20	20-25	
h6	-0,006	-0,008	-0,009	-0,011	-0,013	-0,015

Length L<sub>1+0,5</sub>

### Material:

HWS: High alloy cold working steel (approx. 12% Chrome) / HSS (HSS steel)

### Material properties:

HWS: high durability, long life  
HSS: extremely high durability for materials which are difficult to work with. High abrasion resistance, high tension strength, high heat resistance.

### Hardness: HRC:

Shank: HWS 60 - 64, HSS 62 - 66  
Head: HWS in HSS 45 - 55

### Finish:

Tempered, hardened, precision-ground shank, trombone head hot forged with the permissible shank to head concentric maximum.

### Opomba | Note

HSS rezilne igle so lahko na zahtevo prevlečene s posebno prevleko. Dobavljiva so tudi potrebna grezila za glavo.

HSS punch pins can be treated with a special surface coating upon request. Available is also needed countersink head.



Ø d1 h6	Stopnjevanje Gradiation d1	Ø d2 -0,2	H1 +0,2	a ±0,1	d3	r 0 -0,2	L1+0,5				
							71	80	100	110	120
2,0	0,1	3,0	3,0	1,0	d1±0,01	3,5	●	●	●	●	●
≥2,1		3,2					●	●	●	●	●
2,2								●	●		
≥2,3		3,5				5,0	●	●	●	●	●
2,4							●		●		
2,5							●	●	●		
≥2,6		4,0				6,5	●	●	●	●	●
2,7							●	●	●		
2,8							●		●		
≥3,0		4,5					●	●	●	●	●
3,1							●	●	●		
3,2							●	●	●		
3,3							●		●		
3,4							●		●		
≥3,5		5,0				8,0	●	●	●	●	●
3,6							●		●		
3,7									●		
3,8								●	●		
3,9									●		
≥4,0		5,5	4,0	1,5			●	●	●	●	●
4,1							●	●	●		
4,2							●	●	●		
4,3								●	●		
4,4									●		
≥4,5		6,0					●	●	●	●	●
4,6									●		
4,7									●		
4,8							●	●	●		
4,9									●		
≥5,0		7,0				10,0	●	●	●	●	●
5,1							●		●		
5,2								●	●		
5,3								●	●		
5,4									●		
≥5,5		8,0					●	●	●	●	●
5,6							●	●	●		
5,7							●	●	●		
5,8									●		
5,9									●		
6,0	0,5	9,0					●	●	●	●	●
6,1									●		
6,2									●		
6,3									●		
6,4									●		
≥6,5		10,0				12,0	●	●	●	●	●
6,6									●		
6,7									●		
6,8									●		
7,0							●	●	●		
≥7,5		11,0					●	●	●	●	●
8,0							●	●	●		

# 3 Rezilna igla Punch Pin

# Pozavnasta rezilna igla Bottle-neck punch

Ø d1 h6	Stopnjevanje Gradation d1	Ø d2 -0,2	H1 +0,2	a ±0,1	d3	r 0 -0,2	L1+0,5					
							71	80	100	110	120	
8,1							•		•			
8,2										•		
8,3										•		
8,4										•		
≥ 8,5		13,0			d1±0,02	15,0	•	•	•	•	•	•
9,0							•	•	•			
9,4										•		
9,5		14,0					•	•	•	•	•	•
10,0							•	•	•	•	•	•
10,50		15,0					•	•	•	•	•	•
11,00							•	•	•	•	•	•
11,50		16,0					•	•	•	•	•	•
12,00							•	•	•	•	•	•
12,5		17,0					•	•	•			•
13,00	1,0	17,0					•	•	•	•	•	•
13,5		18,0					•	•	•			•
14,00		18,0					•	•	•	•	•	•
14,50		19,0					•	•	•	•	•	•
15,00							•	•	•	•	•	•
15,5		20,0					•	•	•			•
16,00		20,0					•	•	•	•	•	•
16,5		21,0					•	•	•			•
17,00		21,0					•	•	•	•	•	•
17,5		22,0					•	•	•			•
18,00		22,0					•	•	•	•	•	•
18,5		23,0					•	•	•			•
19,00		23,0					•	•	•	•	•	•
19,5		25,0					•	•	•			•
20,00		25,0					•	•	•	•	•	•
22,00		27,0					•	•	•	•	•	•
25,00		30,0					•	•	•	•	•	•



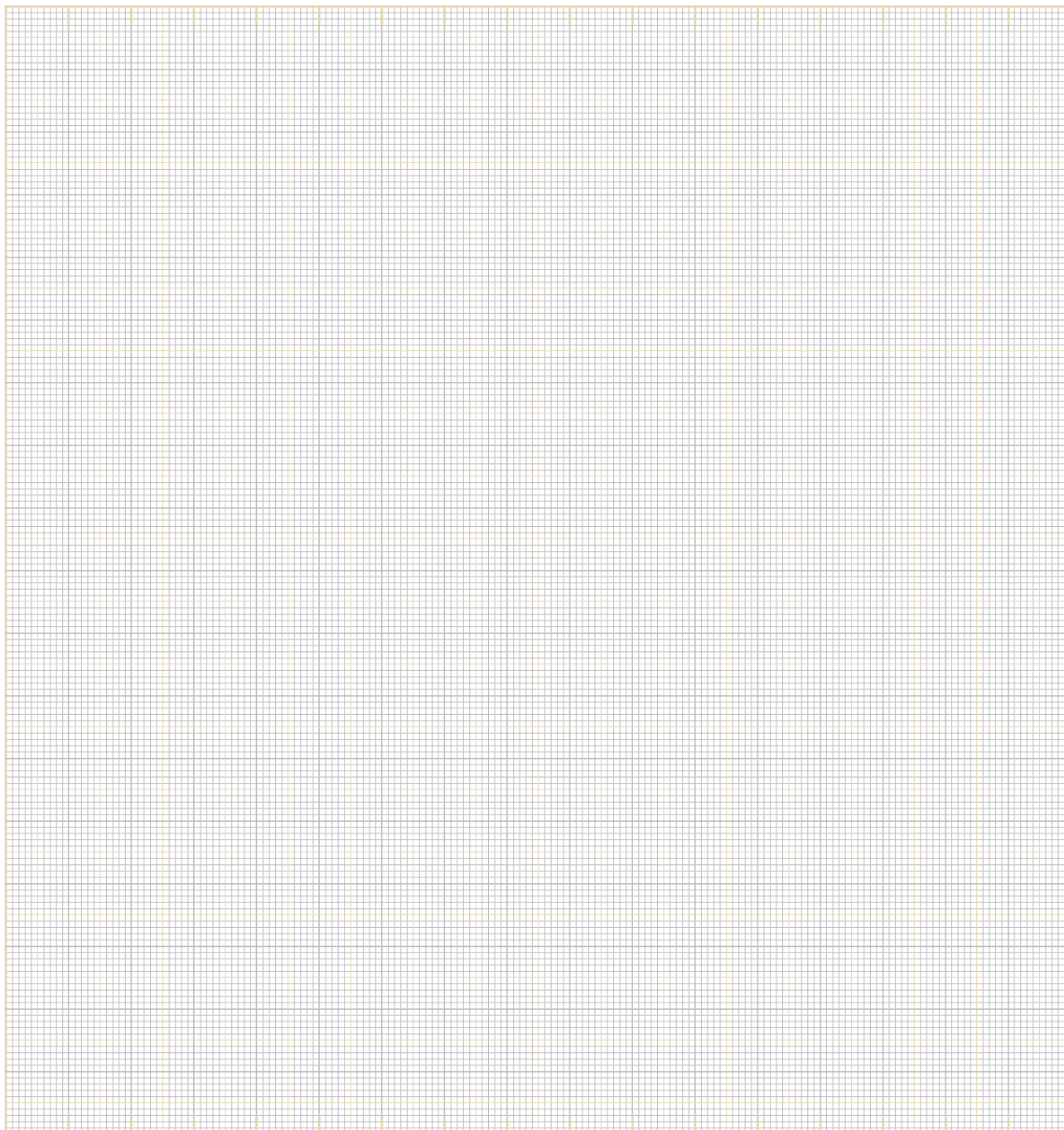

---

---

---