

4 Zatiči Dowel Pin

ISO 4247 DIN 172

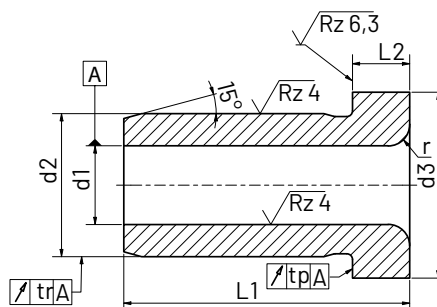

$$\sqrt{Rz\ 25} \left(\sqrt{Rz\ 4} \sqrt{Rz\ 6,3} \right)$$



Vrtalna tulka z glavom.

Drill Bush with head.

Zunaj in znotraj obdelano v zahtevanih tolerancah.

Dimenzije so prikazane v tabeli.

Inside and outside grinded in tolerance, with insertion chamfer.

The dimensions are shown in the table.

Tipi:

- Tip A:** 7619.
Zaokroženo na eni strani
- Tip B:** 7629.
Zaokroženo na obeh straneh

Types:

- Type A:** 7619.
Bore radiused at one end
- Type B:** 7629.
Bore radiused at both ends

Material:

Jeklo, ki ga izbere proizvajalec.

Material:

Steel chosen by manufacturer.

Trdota:

740 + 80 HV 10

Hardness:

740 + 80 HV 10



d1 F 7	a ±0,01	l1			d2 1) n 6	d3	l2	r +0,5 0	tr	tp
		kratek / short	srednji / medium	dolg / long						
0,4- 0,8		6	/	/	3	6	2,0	1	0,01	0,03
0,9- 1,0			9	/	3	6				
1,1- 1,8					12	7				
1,9- 2,6					16	8				
2,7- 3,3		8	12	16	6	9	2,5			
3,4- 4,0					7	10				
4,1- 5,0					8	11				
5,1- 6,0		10	16	20	10	13	3,0	1,5	0,02	
6,1- 8,0					12	15				
8,1-10,0	Graded bores d1 < 15 in increments of 0.1 > 15 preferably 0.5 mm	12	20	25	15	18		2,0		
10,1-12,0					18	22	4,0			
12,1-15,0		16	28	36	22	26				
15,5-18,0					26	30				
18,5-22,0		20	36	45	30	34	5,0	3,0		
22,5-26,0				35	39					0,05
26,5-30,0		25	45	56	42	46				
30,5-35,0					48	52				
35,5-42,0		30	56	67	55	59		3,5		
42,5-48,0					62	66				0,04
48,5-55,0					70	74	6,0			
55,5-63,0		35	67	78	78	82		4		

1) Za vrtnanje s tolerančnim območjem H 6 ali H 7. / For drilling with tolerance range H 6 or H 7 in jig/fixture.