

3 Prebijalna igla Cutting Punch

DIN ISO 8020 E

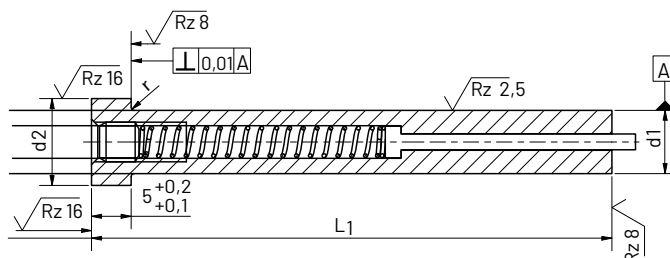

Precizna izvedba rezilne igle s cilindričnima stebлом in glavo ter z odlepnikom.

Precision designed Punch Pins with cylindrical shank and the head with ejector.

Obseg uporabe:

V rezilnih (prebijalnih) orodjih za rezanje lukenj v jeklo (perforacija). Posebej primerne za hiter izmet direktno iz matric. Dimenzije so prikazane v tabeli.

Range of application:

In cutting (punching) tools for cutting holes in steel (perforation). Especially suitable for rapid ejection directly from the matrix. The dimensions are shown in the table.

Prileganje / Toleranca:

| Ø | 5+6 | 8+10 | 13+16 | 20+25 | 32 |
|----|--------|--------|--------|--------|--------|
| | +0,009 | +0,012 | +0,015 | +0,017 | +0,020 |
| M5 | +0,004 | +0,006 | +0,007 | +0,008 | +0,009 |

Steblo premer d_1 , dolžina L_1

Fit / Tolerance:

| Ø | 5+6 | 8+10 | 13+16 | 20+25 | 32 |
|----|--------|--------|--------|--------|--------|
| | +0,009 | +0,012 | +0,015 | +0,017 | +0,020 |
| M5 | +0,004 | +0,006 | +0,007 | +0,008 | +0,009 |

Shank diameter d_1 , the length of L_1

Material:

HSS (hitrorezno jeklo)
CPM 10 V

Material:

HSS (High speed steels)
CPM 10 V

Karakteristike:

HSS: z ekstremno visoko trpežnostjo ali za materiale, s katerimi se težko dela. Velika odpornost proti obrabi, visoka natezalna trdnost, visoka odpornost proti pregretju.

Material properties:

HSS: with extremely high durability for materials that are difficult to process. High wear resistance, high tensile strength, high resistance to overheating.

Opomba | Note

Te rezilne igle so v celoti dobavljive s posebnimi vzmetmi, vijakom ter izmetačem. Trdota vzmeti se nastavlja z vijakom na glavi.

These punch pins are fully supplied with the special springs, screws and ejectors. The spring tension is adjustable.

Trdota:

Steblo: HRC 62 ± 2
Glava: HRC 52 ± 5

Hardnes:

Shaft: HRC 62 ± 2
Head: HRC 52 ± 5

Obdelava:

Kaljeno, popuščano, cilindrična vroče kovana glava, steblo naknadno brušeno po celotni dolžini, vključno pod glavo, z radiusom, brušena površina glave.

Finish:

Hardened, tempered, hot-forged cylinder head, subsequently ground over the entire length, including under the head radius, head surface ground.



HSS

| Ø d1 m5 | Ø d2 0 -0,15 | r ±0,1 0 | H +0,25 | E | L1 +0,5; +0,2 | | | | | |
|---------------|-----------------------|----------------|------------|-----|------------------|----|----|----|-----|-----|
| | | | | | 63 | 71 | 80 | 90 | 100 | 120 |
| 4 | 6 | 0,3 | 5 | 1,0 | | | | | | |
| 5 | 8 | | | | • | • | • | • | • | |
| 6 | 9 | | | | • | • | • | • | • | • |
| 8 | 11 | | | | • | • | • | • | • | • |
| 10 | 13 | | | 1,4 | • | • | • | • | • | • |
| 13 | 16 | 0,4 | | | • | • | • | • | • | • |
| 16 | 19 | | | 2,1 | • | • | • | • | • | • |
| 20 | 23 | | | | • | • | • | • | • | |
| 25 | 26 | | | | • | • | • | • | • | |
| 32 | 35 | | | | • | • | • | • | • | |

CPM 10V

| Ø d1 m5 | Ø d2 0 -0,15 | r ±0,1 0 | T+0,25 | E | L1 +0,5; +0,2 | | | | | |
|---------------|-----------------------|----------------|--------|-----|------------------|----|----|----|-----|-----|
| | | | | | 63 | 71 | 80 | 90 | 100 | 120 |
| 6 | 9 | 0,3 | | | • | • | • | • | • | • |
| 8 | 11 | | | | • | • | • | • | • | • |
| 10 | 13 | | | 1,4 | | • | • | • | • | • |
| 13 | 16 | 0,4 | | | | • | • | • | • | • |
| 16 | 19 | | | 2,1 | • | • | • | • | • | • |
| 20 | 23 | | | | • | • | • | • | • | • |

C