

2 Izmetalna igla Ejector Pin

DIN ISO 8693 F

Nitrirana in oksidirana / Nitrided & Oxidized

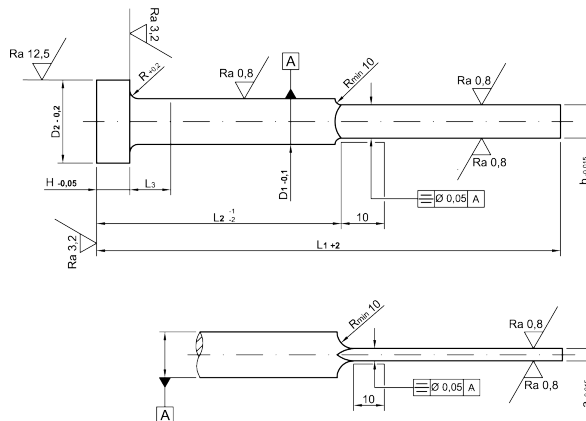

Izmetalna igla s cilindrično glavo in ploščatim reducirnim delom.

Ejector pins with cylindrical head and flat reduced point.

Obseg uporabe:

Za izmet oblikovnih delov iz orodja za tlačno litje, posebej za visoko taleče se lagure. Ploščate izmetalne igle se vedno uporabljajo na mestih, kjer je uporaba okroglih izmetalnih igel neprimerna.

Range of application:

Injection moulding and die-casting, especially for high melting alloy. Flat ejector pins are still used in places where the use of circular ejector pins are inappropriate.

Prileganje / Toleranca:

Pravokotna dolžina	$a+b - 0.015 - 0.015$
Premer stebra	$d_{1-0,1}$
Celotna dolžina	L_{1+2}
Steblo	$L_{2-1/-2}$

Fit / Tolerance:

Perpendicular length	$a+b - 0.015 - 0.015$
Shaft diameter	$d_{1-0,1}$
Complete length	L_{1+2}
Stem	$L_{2-1/-2}$

Material:

WAS (vroča delovna kovina), primerna za nitiranje.

Material:

WAS (hot-work tool steel) suitable for nitriding.

Št. materiala:

- 1.2343 (x38 Cr Mo V51)
- 1.2344 (x 40 Cr Mo V51)

Material Number:

- 1.2343 (X38 Cr Mo V51)
- 1.2344 (X 40 Cr Mo V51)

Karakteristike:

Obstojnost do 600°C/1112°F

Material properties:

Resistant up to 600 °C / 1112 °F

Trdota:

Steblo: ~950 HV 0,3 na površini
Natezna trdnost jedra pribl.
1400 N/mm²
Glava: HRC 45 +10/-5

Hardness:

Shank: ~950 HV"0,3 on surface
Core tensile strength approx.
1400 N/mm²
Head: HRC 45 +10/-5

Opomba | Note

Izmetalne igle je preprosto skrajšati na katerokoli željeno dolžino, ne da bi odluščili nitirno plast.

Ejection pins are easy reduced to any desired length, without peeled off nitrided layer.

Obdelava:

Steblo in ploščati reducirni del sta brušena, vroče kovana cilindrična glava, plazma nitrirano in črno oksidirano, korozijsko odporno.

Finish:

Shank and flat reduced point are ground, hot-forged cylindrical head, plasma nitrided and black oxidized, non corrosive.



Ø b+a -0,015 [mm]	Ø D1 -0,1 [mm]	D3 x H -0,2 / -0,05 [mm]	R +0,2 [mm]	R min	Model AF02									
					63 32 (30) 31 (33)	80 40 40	100 50 50	125 63 (60)* 62 (65)*	160 80 80	200 100 100	250 125 125	315 160 155	400 200 200	
2,8x0,8	3,0	6x3	0,3	10			●	●	●	●				
2,8x1,0							●	●	●	●				
3,5x0,8	4,0	8x3			●	●	●	●	●					
3,5x1,0					●	●	●	●	●					
3,5x1,2					●	●	●	●	●					
3,5x1,0	4,2				●	●	●	●	●	●				
3,8x0,8					●	●	●	●	●	●	●			
3,8x1,0					●	●	●	●	●	●	●	●		
3,8x1,2						●	●	●	●	●	●	●		
4,5x1,0	5,0	10x3				●	●	●	●	●	●	●		
4,5x1,2						●	●	●	●	●	●	●		
4,5x1,5						●	●	●	●	●	●	●		
5,5x1,0	6,0	12x5	0,5			●	●	●	●	●	●	●	●	
5,5x1,2						●	●	●	●	●	●	●	●	
5,5x1,5						●	●	●	●	●	●	●	●	
5,5x2,0						●	●	●	●	●	●	●	●	
7,5x1,2	8,0	14x5					●	●	●	●	●	●	●	
7,5x1,5							●	●	●	●	●	●	●	●
7,5x2,0							●	●	●	●	●	●	●	●
9,5x1,5	10,0	16x5							●	●	●	●	●	
9,5x2,0									●	●	●	●	●	●
11,5x2,0	12,0	18x7	0,8							●	●	●	●	●
11,5x2,5										●	●	●	●	●
15,5x2,0	16,0	22x7								●	●	●	●	●
15,5x2,5												●	●	●