

# 3 Prebijalna igla Cutting Punch

## DIN ISO 8020 C

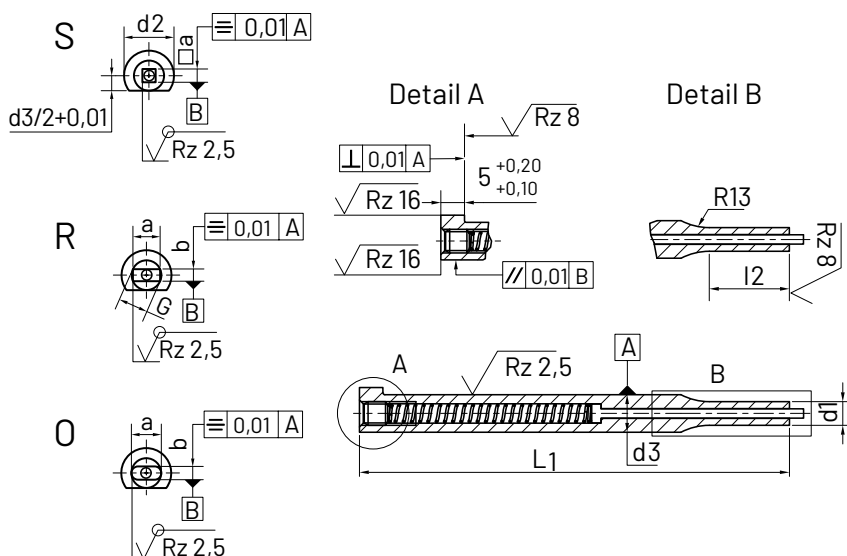

### Prebijalna igla s cilindrično glavo.

Cutting Punch with  
cylindrical head.

#### Obseg uporabe:

Rezilna igla s cilindrično glavo  
in reducirnim delom v obliki  
pravokotnika ali ovala, podobna  
standardu DIN ISO 8020 tip C.

Dimenzije so prikazane v tabeli.

#### Tipi:

**Tip CS:** reducirni del v obliki kvadrata

**Tip CR:** reducirni del v obliki  
pravokotnika

**Tip CO:** reducirni del v obliki ovala /  
zaobljenega pravokotnika

#### Material:

HWS (visoko legirno jeklo za delo v  
hladnem - 12% krom) / HSS (hitrorezno  
jeklo) / ASP 23 (polprašno orodno jeklo  
Vanadis 23) / HM (karbidna kovina)

Na voljo tudi v drugih materialih.

Poglejte tabelo matererialov.

#### Različica in trdota:

Umestitev ravnega dela je vedno na  
daljši strani glede na smer na glavi. Če  
želite, vam lahko spremenimo orodje,  
da je ravna ploskev na krajši strani.

#### Range of application:

Punch with cylindrical head and with  
stepped pin, rectangular and round  
elongated point similar to DIN ISO  
8020 standard type C.

The dimensions are shown in the  
table.

#### Types:

**Type CS:** square stepped cutting shaft

**Type CR:** rectangular stepped  
cutting shaft

**Type CO:** oblong stepped cutting shaft

#### Material:

HWS High alloy cold working steel  
(approx. 12% Chrome) / HSS (High  
speed steels) / ASP 23 - non cobalt  
grade for high performance cutting  
tools, cold work tools / HM (hardmetall)

Other materials available on request,  
see material table.

#### Version and Hardness:

The locating flat can always be found  
on the longest side. If desired, we can  
modify the tool so that the locating  
flat is on the shortest side.

#### Opomba | Note

Rezilni klini-izbijači niso na zalogi,  
vendar jih lahko izdelamo v kratkem  
času. Varnostni zaklop je vedno na  
dolgi strani. Na zahtevo lahko izdelamo  
varnostni zaklop proti zasuku tudi na  
kratki strani. Dostava poteka, odvisno od  
razpoložljivosti, s križno luknjo.

Cutting punches are not stocked, but  
can be produced at short notice. The  
anti-twist lock is always at the longest  
form side. On request, we can manufac-  
ture the anti-twist lock at the short form  
side. The delivery takes place, depend-  
ing on availability, with cross hole.



| a<br>± 0,01   | b<br>± 0,01 | d <sub>2</sub><br>0<br>- 0,15 | d <sub>3</sub><br>m5 | H<br>+ 0,2<br>+ 0,1 | r<br>+ 0,5<br>0 | L <sub>2</sub><br>+ 0,5<br>0 | L <sub>1</sub><br>+ 0,5<br>+ 0,2 |    |    |     |
|---|-------------|-------------------------------|----------------------|---------------------|-----------------|------------------------------|----------------------------------|----|----|-----|
|   |             |                               |                      |                     |                 |                              | 71                               | 80 | 90 | 100 |
| Na željo stranke<br>G=max d <sup>3</sup>                |             | 6                             | 4                    | 3                   | 0,2             |                              | ●                                | ●  | ●  | ●   |
|   |             | 8                             | 5                    | 5                   | 0,3             |                              | ●                                | ●  | ●  | ●   |
|   |             | 9                             | 6                    |                     |                 |                              | ●                                | ●  | ●  | ●   |
| At the option<br>of the orderer<br>G=max d <sup>3</sup> |             | 11                            | 8                    |                     |                 |                              | ●                                | ●  | ●  | ●   |
|   |             | 13                            | 10                   |                     |                 |                              | ●                                | ●  | ●  | ●   |
|   |             | 16                            | 13                   |                     | 0,4             |                              | ●                                | ●  | ●  | ●   |
|   |             | 19                            | 16                   |                     |                 |                              | ●                                | ●  | ●  | ●   |
|   |             | 23                            | 20                   |                     |                 |                              | ●                                | ●  | ●  | ●   |
|   | 28          | 25                            |                      |                     |                 | ●                            | ●                                | ●  | ●  |     |
|   |             |                               |                      |                     |                 |                              | ●                                | ●  | ●  | ●   |

Željene velikosti so 10, 13, 17;  
Možne tudi druge dolžine.

Preferred sizes = 10, 13, 17;  
Other lengths possible

## Tipi profilov Type variations

| Punches and dies

Naročite lahko tudi druge tipe profilov. Izdelujemo jih po predloženih skicah iz različnih materialov: HWS, HSS in jekla iz prašne metalurgije. Na željo tudi prevleko.

We can supply these tools according to your requirements from a wide range of materials: HWS, HSS and powder metallurgic steels. Also coated if requested.

