

3 Vodilna matrica Punch Guide Bush

DIN 9845 C

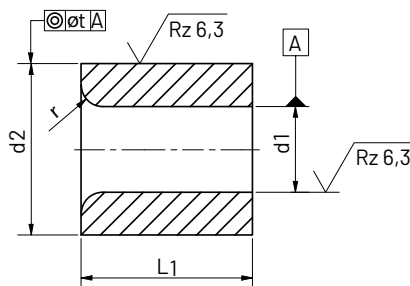

Vodilna matrica tipa C.

Punch guide bush, type C.

Dimenzije so prikazane v tabeli.

The dimensions are shown in the table.

Material:

Jeklo, ki ga po presoji določi proizvajalec.

Material:

Case-hardened steel as chosen by manufacturer".

Trdota:

740 ± 40 HV 10
HRC 62 ± 2

Hardness:

740 ± 40 HV 10
HRC 62 + 2

Obdelava:

Notranjost in zunaj fino brušeno v tolerancah, posneti robovi.

Finish:

Inside and outside grinded in tolerance, with insertion chamfer.

Opomba | Note

Bodite pozorni, ker pri rezilni igli standarda ISO 8020 / 8021 ne moremo zagotoviti primerne razmika - skladnosti prileganja. Standard naj bi bil revidiran.

Please consider ISO 8020 / 8021 that no clearance fit can be assured. The standard is going to be revised.



d1 H7	Stopnjevanje Gradiation	d2 n6	L1	r	t
1,0	0,1	5	9	1	0,01
1,1 - 2,0		6	12		
2,1 - 3,0		7			
3,1 - 4,0		8			
4,1 - 5,0		10	16		
5,1 - 6,0		12		1,5	0,02
6,1 - 8,0		15	20		
8,1 - 10,0		18		2	
10,1 - 12,0		22	28		
12,1 - 15,0		26			
15,5 - 18,0	0,5	30	36		